

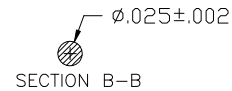

**SOLDER PREFORMS  
HH50A SERIES HEADERS**

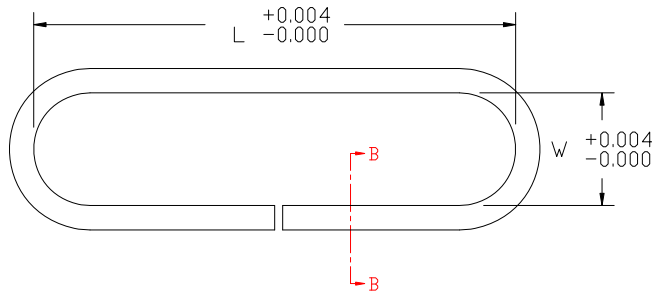

These preforms are designed specifically for SHP HH50A series headers. They provide optimum flow and fillet when used with the recommended preform well and are available in three solder alloys per EIA J-STD-006: Sn63, Sn96 and Sb5.

HEADER SERIES	NO. OF PINS	PREFORM PART NO. (see note 1)	L	W
HH50A	2	HPF50A-2P-xx	.152	.102
	3	HPF50A-3P-xx	.202	.102
	4	HPF50A-4P-xx	.252	.102
	5	HPF50A-5P-xx	.302	.102
	6	HPF50A-6P-xx	.352	.102
	7	HPF50A-7P-xx	.402	.102
	8	HPF50A-8P-xx	.452	.102
	9	HPF50A-9P-xx	.502	.102

Example Part No. HPF50A-2P-63 (slit on length)

Example Part No. HPF50A-2P-W63 (slit on width)

NOTES: (1) Insert last 2 digits of desired solder in place of xx (63, 96 or b5).

Solder Melting Temperatures

Sn63 - 183°C (361°F)

Sn96 - 221°C (430°F)

Sb5 - 232-240°C (450-464°F)

All dimensions are inches.



39 Souhegan Street - P.O. Box 269, Wilton, New Hampshire 03086

TEL (603) 654-2002 FAX (603) 654-2533

email: sales@shp-seals.com - website: www.shp-seals.com

**SOLDER PREFORMS  
HH60 SERIES HEADERS**

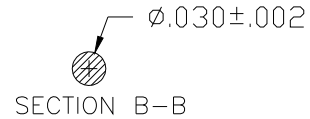
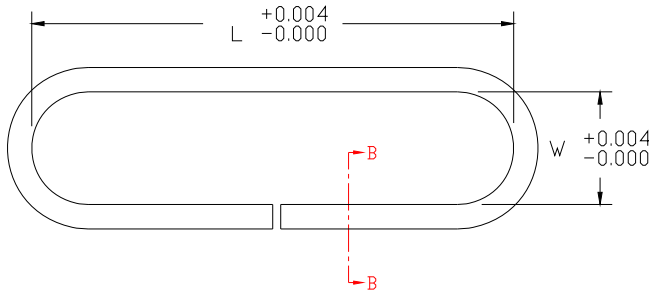

These preforms are designed specifically for SHP HH60 series headers. They provide optimum flow and fillet when used with the recommended preform well and are available in three solder alloys per EIA J-STD-006: Sn63, Sn96 and Sb5.

HEADER SERIES	NO. OF PINS	PREFORM PART NO. (see note 1)	L	W
HH60	2	HPF60-2P-xx	.150	.090
	3	HPF60-3P-xx	.210	.090
	4	HPF60-4P-xx	.270	.090
	5	HPF60-5P-xx	.330	.090
	6	HPF60-6P-xx	.390	.090
	7	HPF60-7P-xx	.450	.090

Example Part No. HPF60-2P-63 (slit on length)

Example Part No. HPF60-2P-W63 (slit on width)

NOTES: (1) Insert last 2 digits of desired solder in place of xx (63, 96 or b5).

Solder Melting Temperatures

Sn63 - 183°C (361°F)

Sn96 - 221°C (430°F)

Sb5 - 232-240°C (450-464°F)

All dimensions are inches.



39 Souhegan Street - P.O. Box 269, Wilton, New Hampshire 03086

TEL (603) 654-2002 FAX (603) 654-2533

email: sales@shp-seals.com - website: www.shp-seals.com

**SOLDER PREFORMS  
HH80 & HH100 SERIES HEADERS**

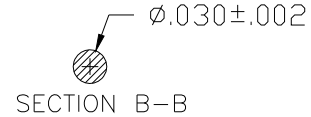
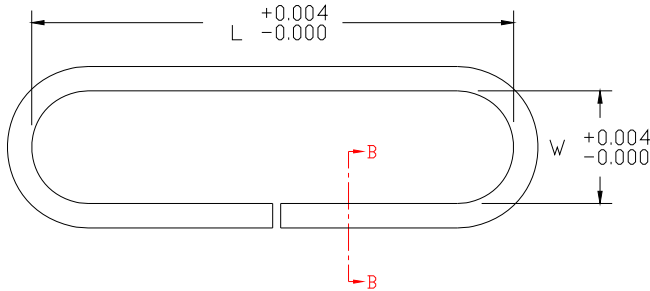

These preforms are designed specifically for SHP HH80 & HH100 series headers. They provide optimum flow and fillet when used with the recommended preform well and are available in three solder alloys per EIA J-STD-006: Sn63, Sn96 and Sb5.

HEADER SERIES	NO. OF PINS	PREFORM PART NO. (see note 1)	L	W
HH80	2	HPF80-2P-xx	.170	.090
	3	HPF80-3P-xx	.250	.090
	4	HPF80-4P-xx	.330	.090
	5	HPF80-5P-xx	.410	.090
	6	HPF80-6P-xx	.490	.090
HH100	2	HPF100-2P-xx	.220	.120
	3	HPF100-3P-xx	.320	.120
	4	HPF100-4P-xx	.420	.120

Example Part No. HPF80-2P-63 (slit on length)

Example Part No. HPF80-2P-W63 (slit on width)

NOTES: (1) Insert last 2 digits of desired solder in place of xx (63, 96 or b5).

Solder Melting Temperatures

Sn63 - 183°C (361°F)

Sn96 - 221°C (430°F)

Sb5 - 232-240°C (450-464°F)

All dimensions are inches.



**SOLDER PREFORMS  
HHCA SERIES HEADERS**

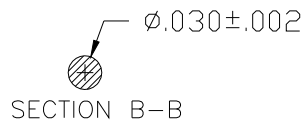
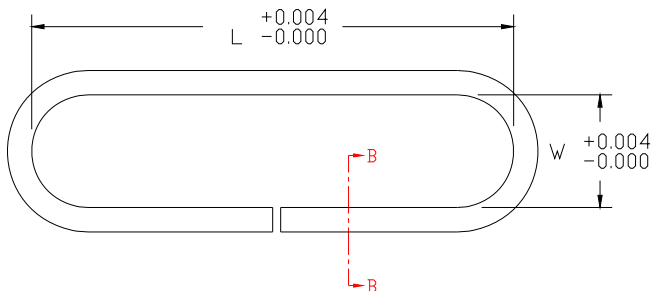

These preforms are designed specifically for SHP HHCA series headers. They provide optimum flow and fillet when used with the recommended preform well and is available in one solder alloy per EIA J-STD-006: Sn63

HEADER SERIES	NO. OF PINS	PREFORM PART NO. (see note 1)	L	W
HHCA	2	HPFCA-2P-63	.220	.100
	3	HPFCA-3P-63	.340	.100
	4	HPFCA-4P-63	.460	.100

Example Part No. HPF80-2P-63 (slit on length)

Example Part No. HPF80-2P-W63 (slit on width)

Solder Melting Temperature  
Sn63 - 183°C (361°F)

All dimensions are inches.