



39 Souhegan Street - P.O. Box 269, Wilton, New Hampshire 03086

TEL (603) 654-2002 FAX (603) 654-2533

email: sales@shp-seals.com - website: www.shp-seals.com

SOLDER PREFORMS
CIRCULAR

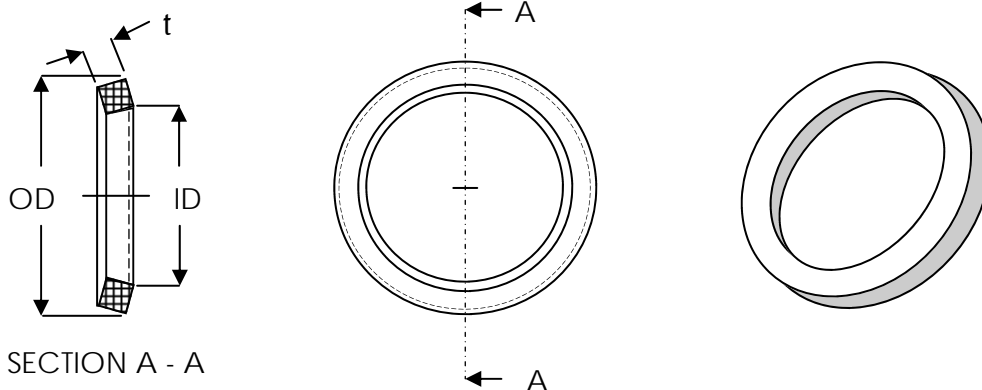

These preforms are designed specifically for SHP series feedthrus, ground pins and capacitors. They provide optimum flow and fillet when used with the recommended preform well and are available in three solders: Sn63, Sn96 and Sb5.

FEEDTHRU SERIES	PREFORM PART NO.	DIMENSIONS ⁽⁶⁾			RECOMMENDED WELL ⁽⁶⁾	
		ID	OD	t	Dia.	Depth
SHP60	SPPF-60xx	.054	.090	.020	.096	.012
SHP74B	SPPF-74Bxx	.068	.120	.025	.124	.012
SHP74C	SPPF-74Cxx	.068	.108	.020	.114	.012
SHP74D	SPPF-74Dxx ⁽²⁾	.068	.108	.018	.114	.012
SHP86	SPPF-86xx ⁽³⁾	.080	.120	.020	.126	.012
SHP98	SPPF-98xx ⁽⁴⁾	.092	.134	.020	.140	.012
SHP11	SPPF-11xx	.105	.145	.020	.150	.012
SHP12	SPPF-12xx	.114	.154	.020	.160	.012
SHP13	SPPF-13xx	.132	.192	.025	.198	.012
SHP13A	SPPF-13Axx	.130	.173	.025	.182	.012
SHP15	SPPF-15xx	.152	.194	.020	.200	.012
C88 ⁽⁵⁾	SPPF-88xx	.083	.138	.025	.142	.025
C99 ⁽⁵⁾	SPPF-99xx	.095	.132	.014	.142	.010

Example Part No. SPPF-1363

- NOTES: (1) Insert last 2 digits of desired solder in place of xx (63, 96 or b5).
(2) Also used on SHP7609 series
(3) Also used on SHP86B series and C74A & C74B series capacitors
(4) Also used on SHP98A & SHP98B series
(5) Not available in Sb5
(6) Tolerance on all dimensions is ±.002

Solder & Melting Temperatures

- Sn63 - 183°C (361°F)
- Sn96 - 221°C (430°F)
- Sb5 - 232-240°C (450-464°F)

All dimensions are inches.